



Externally Mounted Ventilators – Install Quick Specs VEN100E

Installation Type & Discharge Direction

Mounted outside. Can be mounted on exterior roof or wall.

Ventilator Carton Weight:

VEN100E = 80 lbs.

CFM Rating

1000 CFM = VEN100E

Minimum Duct Size

10" round

Maximum Equivalent Straight Duct Length

50 feet

Equivalent Straight Lengths

- 1 foot of 8" or 10" duct = 1 foot
- 1 foot of 3 ¼" x 14" rectangular = 1 foot
- 8" round 90 degree Elbow = 5 feet
- 10" round 90 degree Elbow = 3 feet
- Wall or Roof Cap = 2 feet

Standard Features

- Adaptable to all Wind Crest hoods
- Weather-resistant galvanized steel construction
- Thermally protected, permanently lubricated motor
- Dynamically balanced 11" diameter blower wheel
- Neoprene resilient anti-vibration mounted
- Built-in Flashing plate for roof or wall mount
- Easily removed blower cover for periodic cleaning

Ventilator Motor Ratings*

Hoods without Heat Lamps:

8.0 Amps @ 120 V AC, 60 Hz

Hoods with Heat Lamps:

12.4 Amps @ 120 V AC, 60 Hz

*For maximum power supply required, refer to hood series selected.

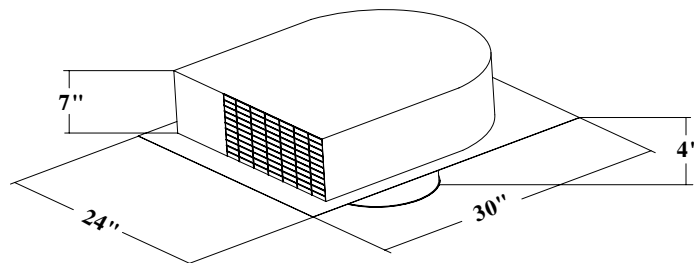

VEN100E



**Internally Mounted Ventilators – Install Quick Specs
VEN100E**

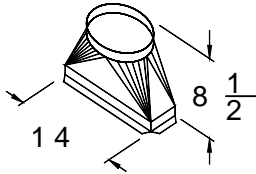

#10100 = 14" w X 4 1/4" d x 8 1/2" h
Rectangular to 8" Round duct

#10287 = 14" w X 4 1/4" d x 8 1/2" h
Rectangular to 10" Round duct

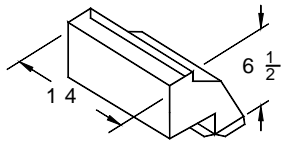

#10099 = 14" w x 4 1/4" d x 6 1/2" h
Rectangular transition

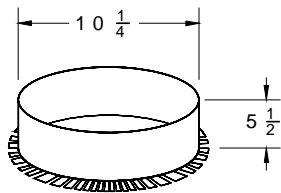

#10172 = 10" round Starting Collar

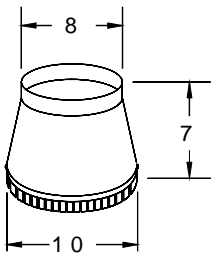

#10173 = 10" to 8" Round Adapter

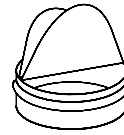

#10288 = 8" Round Backdraft Damper
#10289 = 10" Round Backdraft Damper

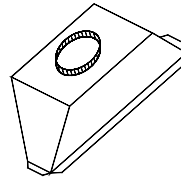

11 1/2" h x 32 3/4" w

#10542 = Plenum Transition to 10" round (use with dual Internal or Remote blower on 48" and larger WSL, WCL, WER60 or PSL66 hoods)

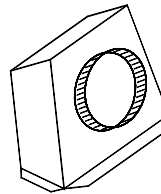

11 1/2" h x 14" w

#10377 = 10" Round Rear Discharge

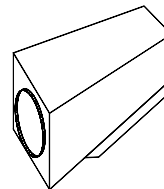

11 1/2" h x 16" w

#10566 = 10" Round Left Side Discharge

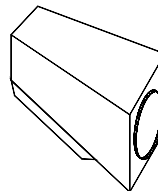

11 1/2" h x 16" w

#10378 = 10" Round Right Side Discharge